

**MORELOS DAM SITE - DREDGE LANDING**  
 Colorado River, Yuma, Arizona Area - River Mile 22.1  
 Site No. 1

NOTE:  
 THIS DRAWING HAS BEEN UPDATED USING THE 1966 PHOTO

<b>ALWAYS THINK SAFETY</b>	
UNITED STATES DEPARTMENT OF THE INTERIOR BUREAU OF RECLAMATION COLORADO RIVER FRONT WORK & LEVEE SYSTEM YUMA AND LIMITOPHE DIVISIONS-ARIZONA-CALIFORNIA	
DESIGNED _____	TECHNICAL APPROVAL _____
DRAWN _____	SUBMITTED _____
CHECKED _____	ADMIN. APPROVED _____
YUMA, ARIZONA      SHEET 2 OF 20      423-303-	

SCALE OF FEET  
 0 1000 2000  
 00' 00" N  
 Arizona State Plane Coordinates West Zone  
 HYDROGRAPHY REVISED JAN 1987  
 BASED ON NOV 1986 PHOTOGRAPHY

**BOAT RAMP SITE - UPSTREAM of YUMA MESA CONDUIT**  
 Colorado River, Yuma, Arizona Area - River Mile 26  
 Site No. 2

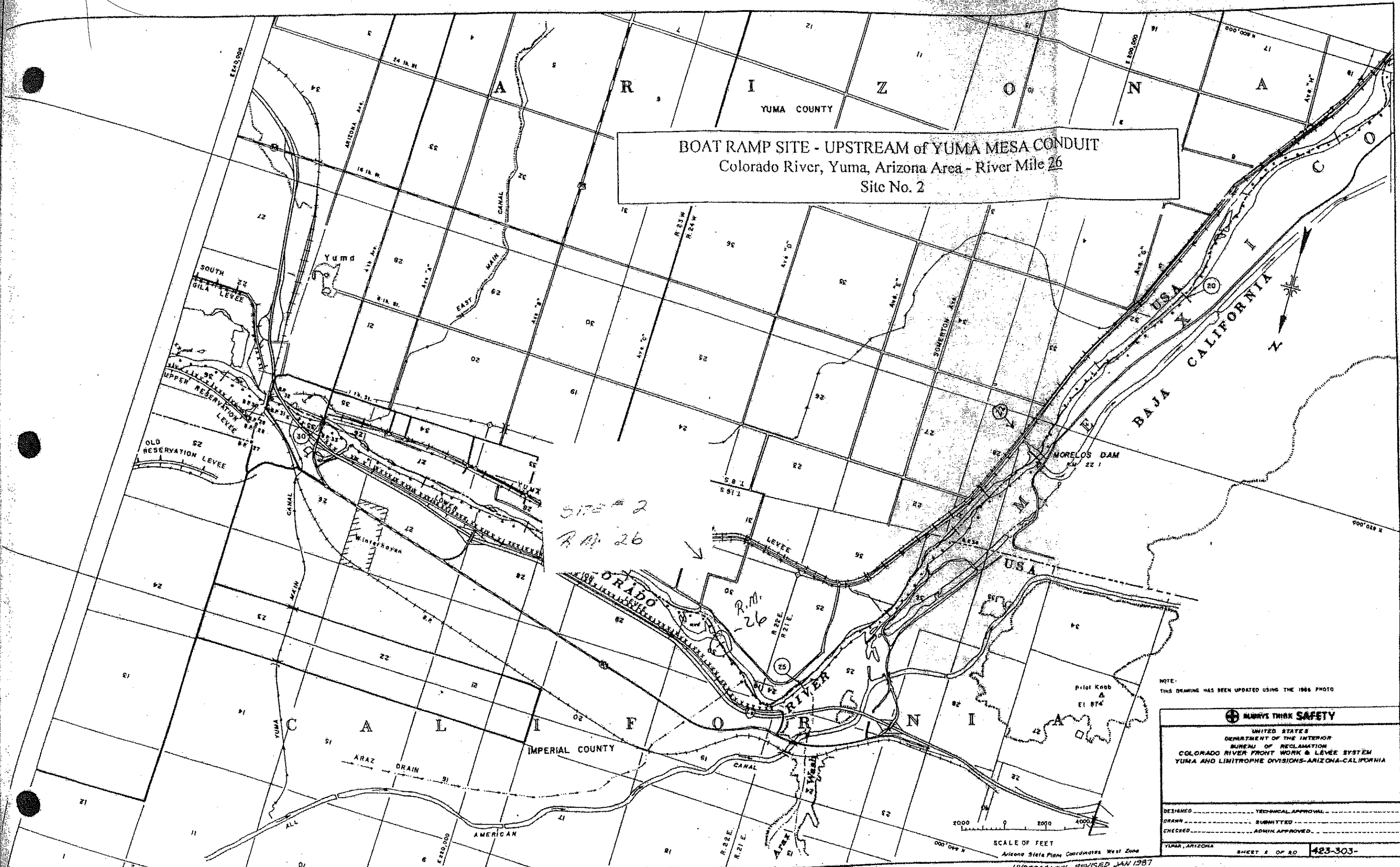

SITE # 2  
 R.M. 26

NOTE:  
 THIS DRAWING HAS BEEN UPDATED USING THE 1986 PHOTO

<b>ALWAYS THINK SAFETY</b>	
UNITED STATES DEPARTMENT OF THE INTERIOR BUREAU OF RECLAMATION COLORADO RIVER FRONT WORK & LEVEE SYSTEM YUMA AND LIMITOPHE DIVISIONS-ARIZONA-CALIFORNIA	
DESIGNED _____	TECHNICAL APPROVAL _____
DRAWN _____	SUBMITTED _____
CHECKED _____	ADMIN. APPROVED _____
YUMA, ARIZONA	SHEET 2 OF 20 <b>423-303-</b>

SCALE OF FEET  
 0 2000 4000  
 Arizona State Plane Coordinates West Zone

HYDROGRAPHY, REVISED JAN 1987  
 BASED ON NOV 1986 PHOTOGRAPHY

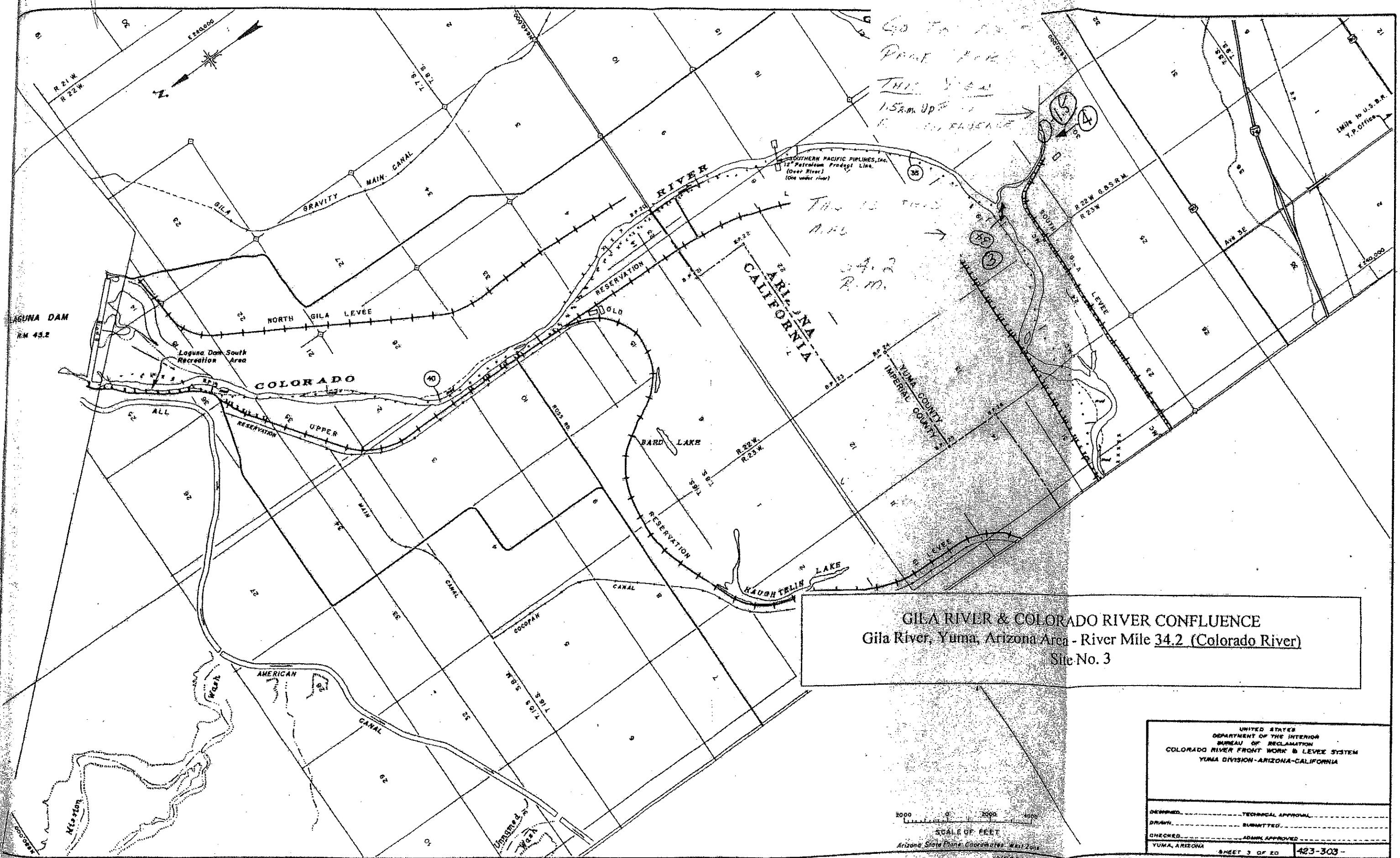

GILA RIVER & COLORADO RIVER CONFLUENCE  
 Gila River, Yuma, Arizona Area - River Mile 34.2 (Colorado River)  
 Site No. 3

UNITED STATES  
 DEPARTMENT OF THE INTERIOR  
 BUREAU OF RECLAMATION  
 COLORADO RIVER FRONT WORK & LEVEE SYSTEM  
 YUMA DIVISION-ARIZONA-CALIFORNIA

DESIGNED \_\_\_\_\_ TECHNICAL APPROVAL \_\_\_\_\_  
 DRAWN \_\_\_\_\_ SUBMITTED \_\_\_\_\_  
 CHECKED \_\_\_\_\_ ADMIN. APPROVED \_\_\_\_\_  
 YUMA, ARIZONA SHEET 3 OF 20 423-303-

0 2000 4000  
 SCALE OF FEET  
 Arizona State Plane Coordinates West Zone

HYDROGRAPHY REVISED JAN 1987  
 BASED ON NOV 1966 PHOTOGRAPHY

YUMA DIVISION

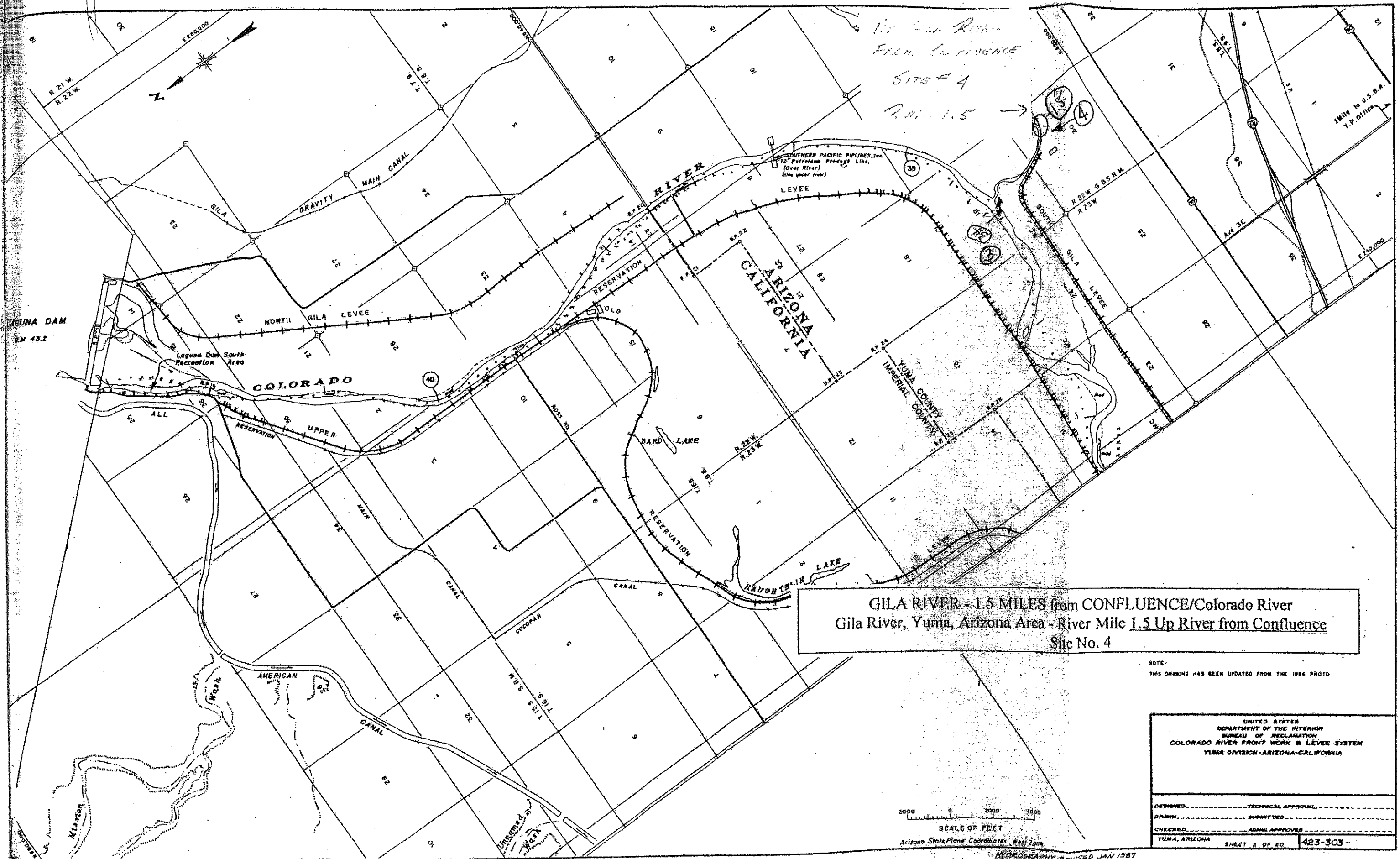

*1.5 Miles River  
FROM CONFLUENCE  
SITE # 4  
R.M. 1.5*

GILA RIVER - 1.5 MILES from CONFLUENCE/Colorado River  
Gila River, Yuma, Arizona Area - River Mile 1.5 Up River from Confluence  
Site No. 4

NOTE:  
THIS DRAWING HAS BEEN UPDATED FROM THE 1986 PHOTO

UNITED STATES  
DEPARTMENT OF THE INTERIOR  
BUREAU OF RECLAMATION  
COLORADO RIVER FRONT WORK & LEVEE SYSTEM  
YUMA DIVISION - ARIZONA-CALIFORNIA

DESIGNED \_\_\_\_\_ TECHNICAL APPROVAL \_\_\_\_\_  
DRAWN \_\_\_\_\_ SUBMITTED \_\_\_\_\_  
CHECKED \_\_\_\_\_ ADMIN APPROVED \_\_\_\_\_  
YUMA, ARIZONA SHEET 3 OF 80 423-303-

2000 0 2000 4000  
SCALE OF FEET  
Arizona State Plane Coordinates West Zone

HYDROGRAPHY REVISED JAN 1987  
BASED ON NOV 1986 PHOTOGRAPHY

YUMA DIVISION

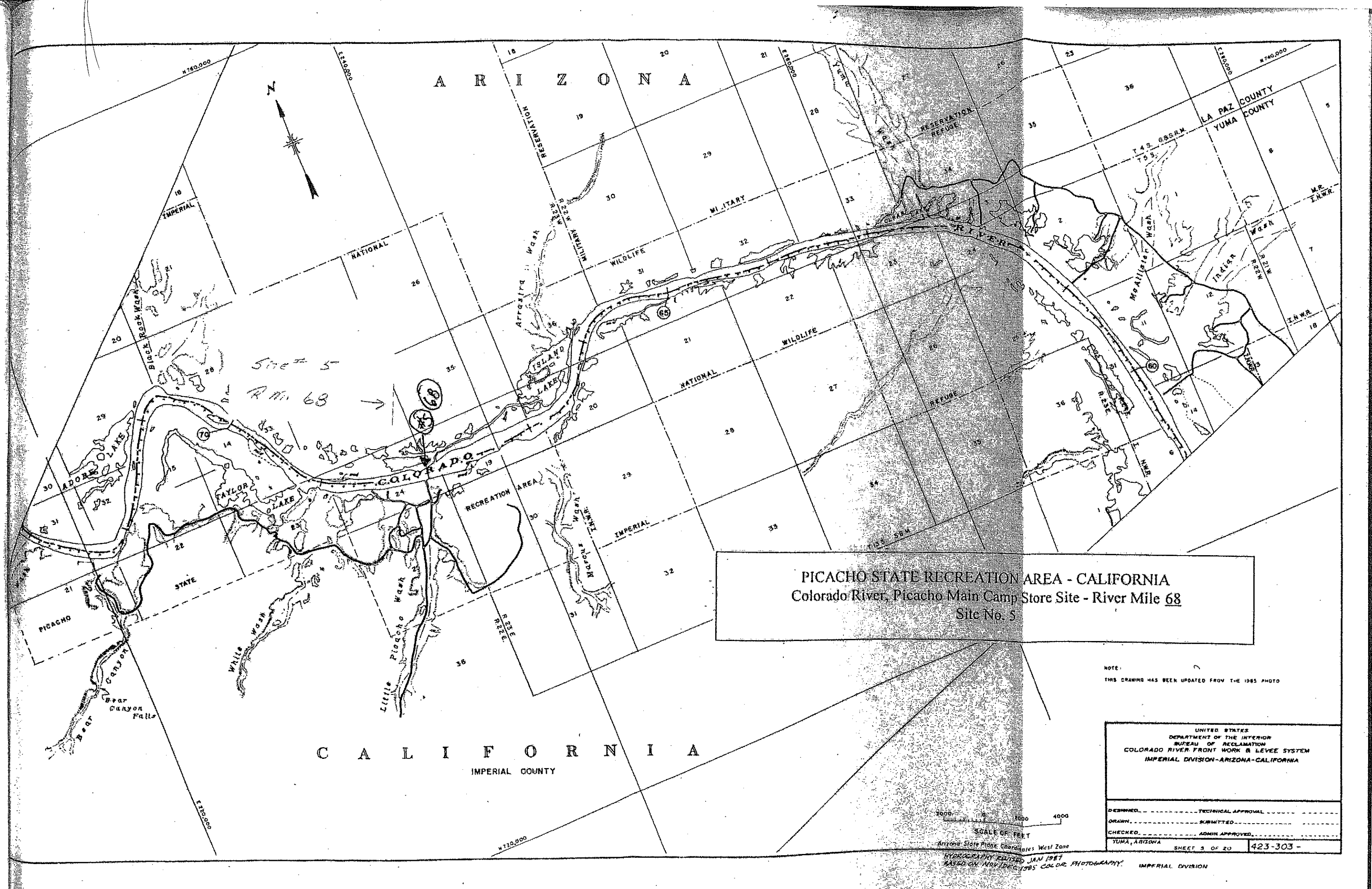

PICACHO STATE RECREATION AREA - CALIFORNIA  
 Colorado River, Picacho Main Camp Store Site - River Mile 68  
 Site No. 5

NOTE:  
 THIS DRAWING HAS BEEN UPDATED FROM THE 1985 PHOTO

UNITED STATES  
 DEPARTMENT OF THE INTERIOR  
 BUREAU OF RECLAMATION  
 COLORADO RIVER FRONT WORK & LEVEE SYSTEM  
 IMPERIAL DIVISION - ARIZONA - CALIFORNIA

DESIGNED \_\_\_\_\_ TECHNICAL APPROVAL \_\_\_\_\_  
 DRAWN \_\_\_\_\_ SUBMITTED \_\_\_\_\_  
 CHECKED \_\_\_\_\_ ADMIN. APPROVED \_\_\_\_\_  
 YUMA, ARIZONA SHEET 5 OF 20 423-303 -

SCALE OF FEET  
 0 1000 2000 4000  
 Arizona State Plane Coordinates West Zone

HYDROGRAPHY REVISED JAN 1987  
 BASED ON NAVY/DEC 1985 COLOR PHOTOGRAPHY  
 IMPERIAL DIVISION

A R I Z O N A

LA PAZ COUNTY

C A L I F O R N I A

PALO VERDE OXBOW OUTLET  
Colorado River, Blythe, California Arca - River Mile 100  
Site No. 6

Site # 6  
R.M. 100

NOTE:  
THIS DRAWING HAS BEEN UPDATED FROM THE 1965 PHOTO

UNITED STATES  
DEPARTMENT OF THE INTERIOR  
BUREAU OF RECLAMATION  
COLORADO RIVER FRONT WORK & LEVEE SYSTEM  
PALO VERDE AND CIBOLA DIVISIONS-ARIZONA-CALIFORNIA

DESIGNED	TECHNICAL APPROVAL
DRAWN	SUBMITTED
CHECKED	ADMIN. APPROVED
YUMA, ARIZONA	
SHEET 6 OF 80	
423-303-	

SCALE OF FEET  
0 2000 4000

REVISED JAN 1967 BASED ON  
NOV/DEC 1966 LARGE PHOTOGRAMMRY

PALO VERDE AND CIBOLA DIVISIONS

Arizona State Plane Coordinates West Zone

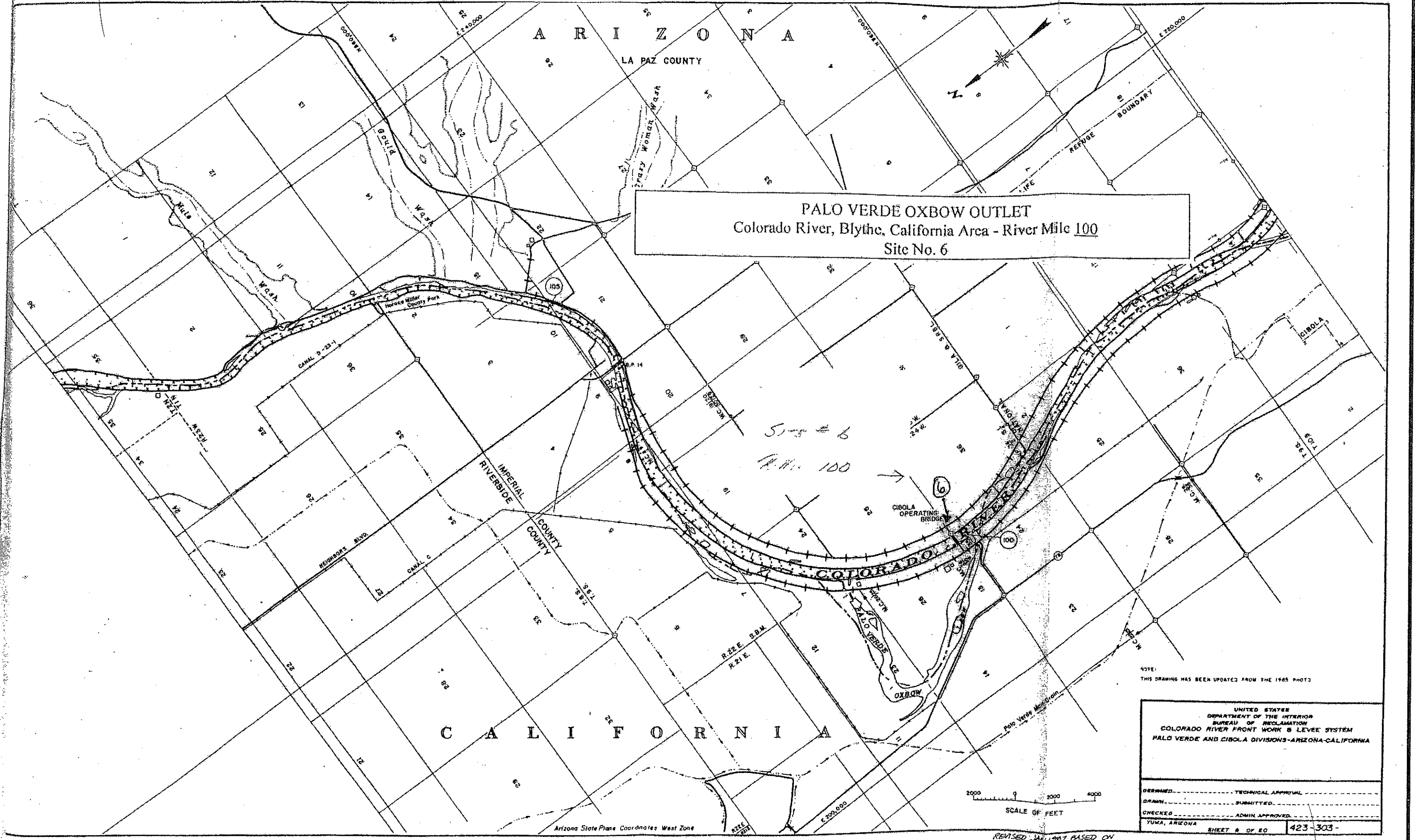

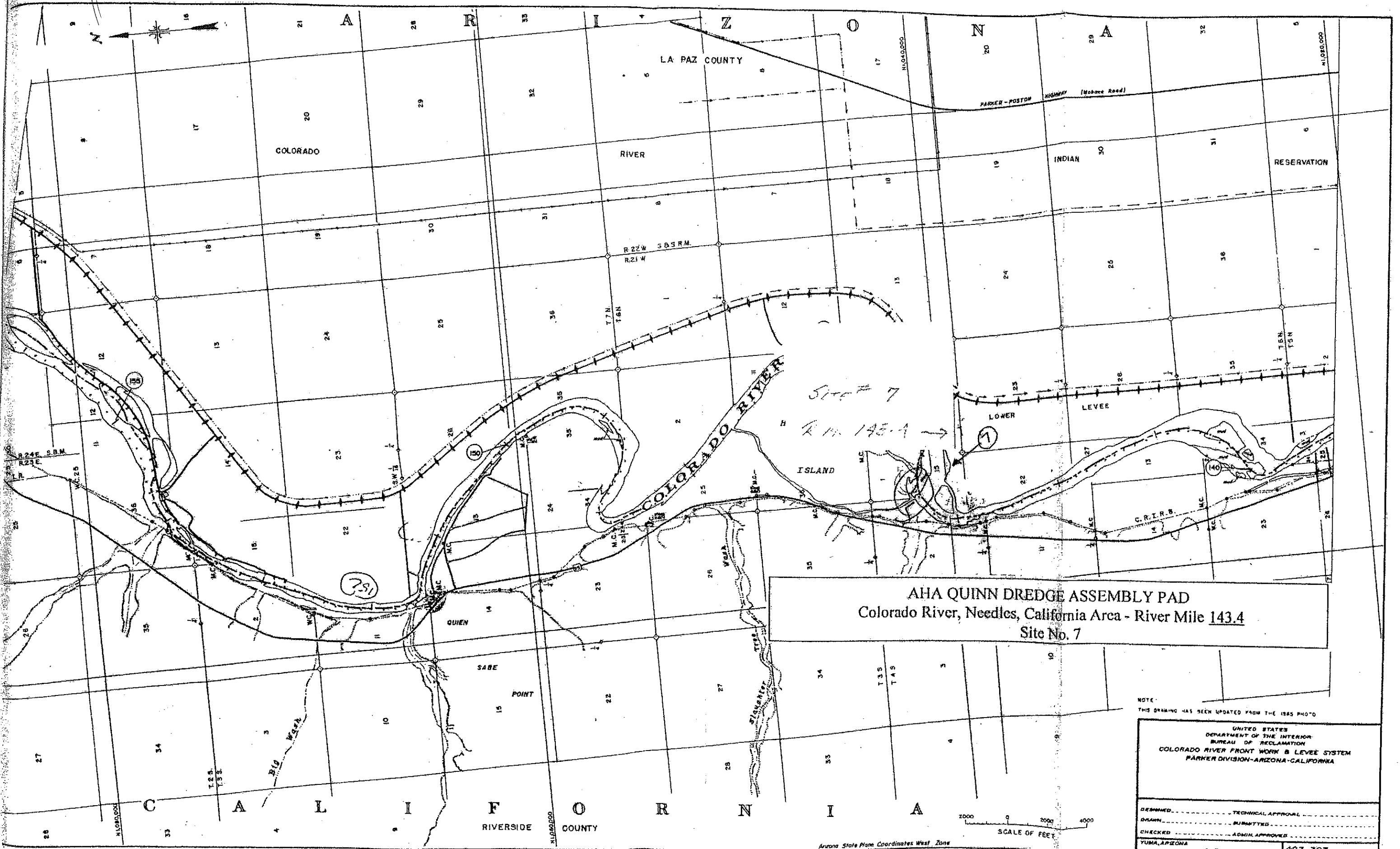

**AHA QUINN DREDGE ASSEMBLY PAD**  
 Colorado River, Needles, California Area - River Mile 143.4  
 Site No. 7

NOTE:  
THIS DRAWING HAS BEEN UPDATED FROM THE 1935 PHOTO

UNITED STATES DEPARTMENT OF THE INTERIOR BUREAU OF RECLAMATION COLORADO RIVER FRONT WORK & LEVEE SYSTEM PARKER DIVISION-ARIZONA-CALIFORNIA	
DESIGNED _____	TECHNICAL APPROVAL _____
DRAWN _____	SUBMITTED _____
CHECKED _____	ADMIN. APPROVED _____
YUMA, ARIZONA	
SHEET 11 OF 20	423-303-

Arizona State Plane Coordinates West Zone

SCALE OF FEET  
0 2000 4000

REVISED FOR 1987 BASED ON  
NAV/DGC 1985 (AERIAL PHOTOGRAPHY)

PARKER DIVISION

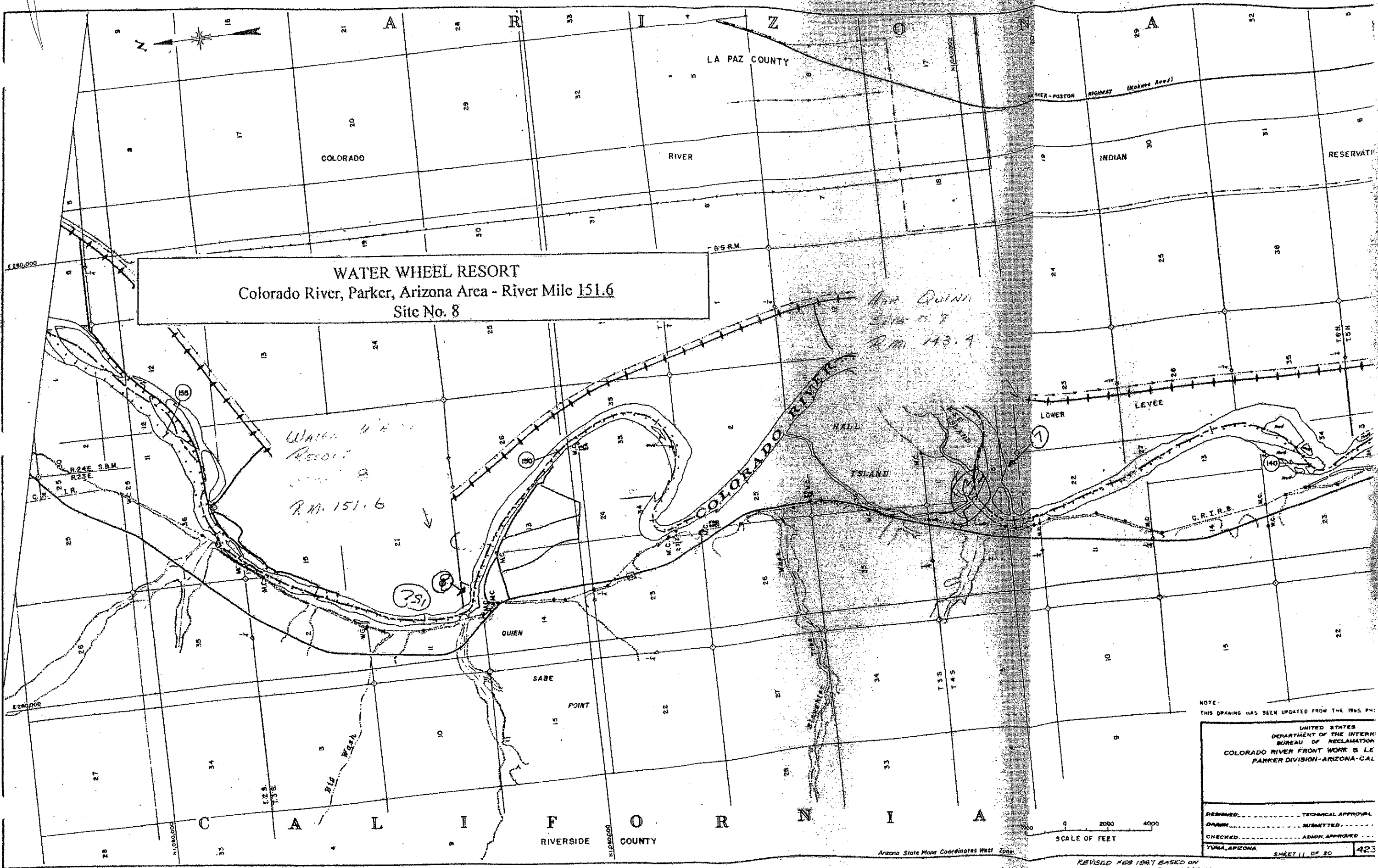

**WATER WHEEL RESORT**  
 Colorado River, Parker, Arizona Area - River Mile 151.6  
 Site No. 8

*WATER WHEEL RESORT  
 R.M. 151.6*

*Area Quin  
 R.M. 143.4*

NOTE: THIS DRAWING HAS BEEN UPDATED FROM THE 1965 PLAN

UNITED STATES  
 DEPARTMENT OF THE INTERIOR  
 BUREAU OF RECLAMATION  
 COLORADO RIVER FRONT WORK & LE  
 PARKER DIVISION-ARIZONA-CAL

DESIGNED	TECHNICAL APPROVAL
DRAWN	SUBMITTED
CHECKED	ADMIN. APPROVED
YUMA, ARIZONA	SHEET 11 OF 20

SCALE OF FEET  
 0 2000 4000

REVISED FOR 1987 BASED ON NOV/DEC 1985 COLOR PHOTOGRAPHY  
 PARKER DIVISION

Arizona State Plane Coordinates West Zone



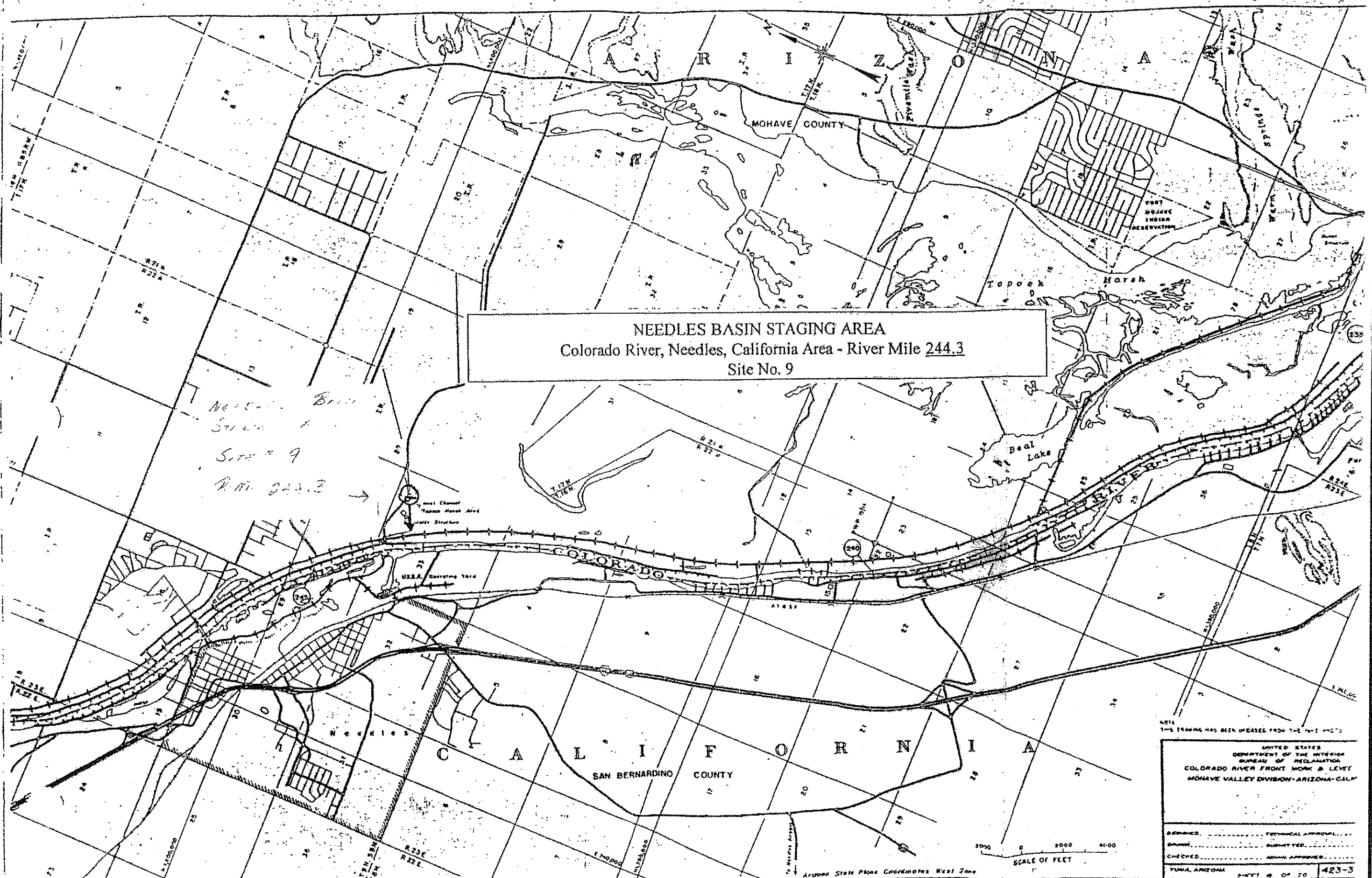

NEEDLES BASIN STAGING AREA  
 Colorado River, Needles, California Area - River Mile 244.3  
 Site No. 9

*Needles Basin  
 Staging Area  
 Site No. 9  
 R.M. 244.3* →

4014 THIS DRAWING HAS BEEN DERIVED FROM THE 1952 PHOTO

UNITED STATES  
 DEPARTMENT OF THE INTERIOR  
 BUREAU OF RECLAMATION  
 COLORADO RIVER FRONT WORK & LEVEL  
 MOHAVE VALLEY DIVISION-ARIZONA-CALIF

DESIGNED	TECHNICAL APPROVAL
DRAWN	SURVEYED
CHECKED	ADMIN. APPROVAL
YUMA, ARIZONA	SHEET # OF 20

SCALE OF FEET  
 0 2000 4000

Arundo State Plane Coordinates West Zone

423-3

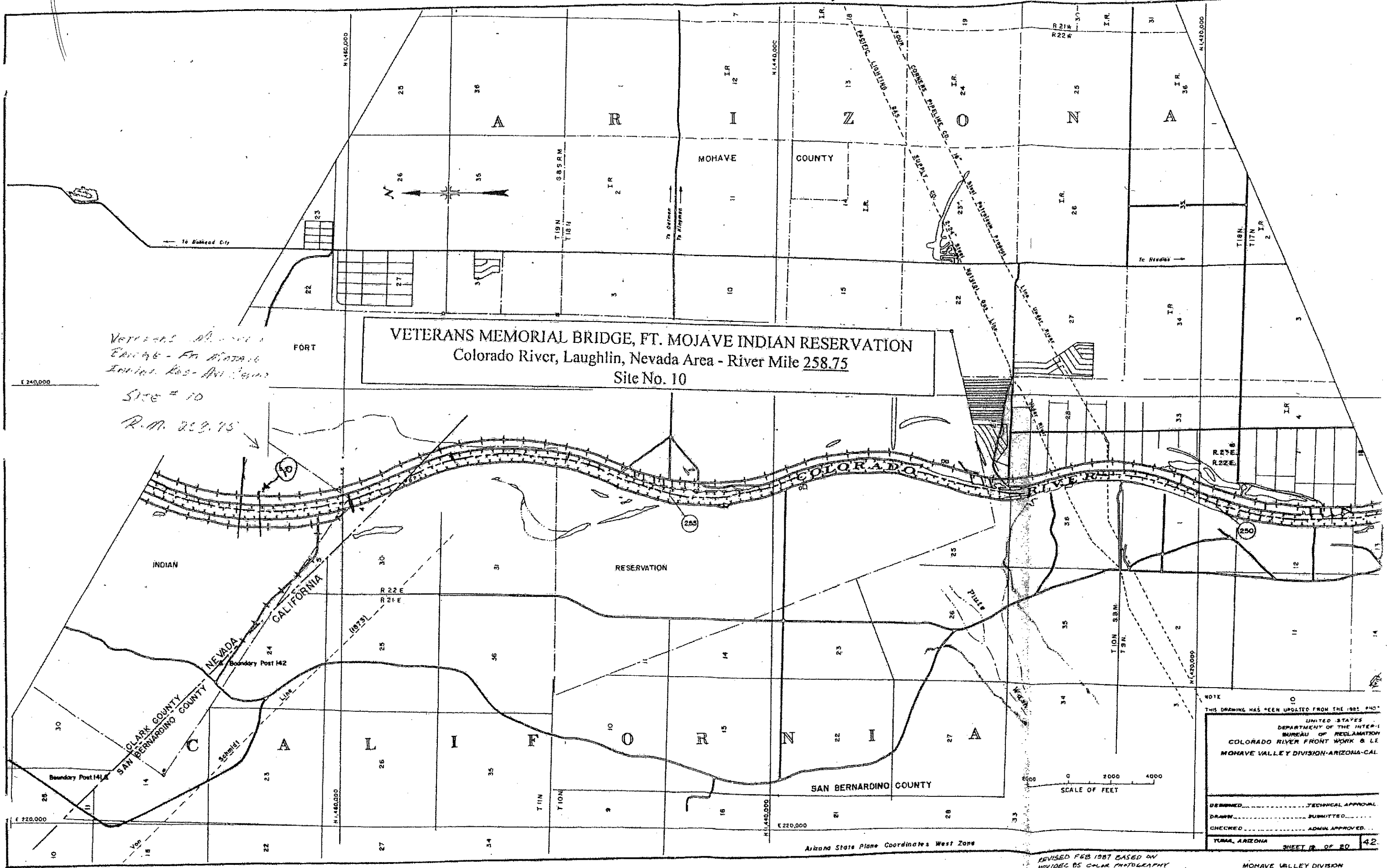

Veterans Memorial Bridge  
 Elevation - Ft. Mojave  
 Indian Res. - Ft. Mojave  
 Site # 10  
 R.M. 258.75

VETERANS MEMORIAL BRIDGE, FT. MOJAVE INDIAN RESERVATION  
 Colorado River, Laughlin, Nevada Area - River Mile 258.75  
 Site No. 10

NOTE  
 THIS DRAWING HAS BEEN UPDATED FROM THE 1985 PHOTO  
 UNITED STATES  
 DEPARTMENT OF THE INTERIOR  
 BUREAU OF RECLAMATION  
 COLORADO RIVER FRONT WORK & LE  
 MOHAVE VALLEY DIVISION-ARIZONA-CAL.

DESIGNED \_\_\_\_\_ TECHNICAL APPROVAL \_\_\_\_\_  
 DRAWN \_\_\_\_\_ SUBMITTED \_\_\_\_\_  
 CHECKED \_\_\_\_\_ ADMIN. APPROVED \_\_\_\_\_

TUMACACI, ARIZONA SHEET 18 OF 20 42

REVISED FEB 1987 BASED ON  
 NOV/DEC 85 COLOR PHOTOGRAPHY

MOHAVE VALLEY DIVISION

Arizona State Plane Coordinates West Zone

SCALE OF FEET  
 0 2000 4000

E 240,000

E 220,000

E 220,000

N 430,000

N 430,000

N 430,000

N 430,000

N 430,000

N 430,000