

51628

When recorded mail to:

State of California
Wildlife Conservation Board
Attention: Executive Director
1416 Ninth Street, Ste. 1266
Sacramento, CA 95814

2017-0001620

Recorded
Official Records
County of
Plumas
KATHY WILLIAMS
Clerk-Recorder

REC FEE 0.00
PCOR-NONE 20.00

10:25AM 10-Apr-2017

SC
Page 1 of 10

SPACE ABOVE THIS LINE FOR RECORDER'S USE

GRANT DEED

Agency: Department of Fish and Wildlife
Wildlife Conservation Board

Project: Crocker Meadows Wildlife Area, Exp. #2

APN's: 025-060-044, 025-060-036, 025-060-035, 025-060-034,
025-060-033, 025-030-032, 025-030-033, 025-030-035,
025-030-040*, 025-030-041, 025-030-043*,
025-030-008, ~~025-030-039*~~, 025-460-003 and 025-030-042*
*portion

Exempt from Recording Fees – Gov. Code Section 27383

Dwight Eugene Ceresola and Carol A. Ceresola, husband and wife as joint tenants (Grantors) hereby GRANTS to the STATE OF CALIFORNIA (Grantee), acting by and through its Department of Fish and Wildlife, the real property described in the attached Exhibit A, which real property is located in the County of Plumas, State of California. Further, Grantors grant and convey to Grantee any and all water rights appurtenant to the real property conveyed to Grantee or held by Grantors, which water rights are identified in the Middle Fork Feather River Decree 3095 and are more particularly described in the division of water rights letter attached hereto as Exhibit B, and incorporated herein by reference.

Dated: 9/7/16

GRANTORS:

By: Dwight Eugene Ceresola
Dwight Eugene Ceresola

By: Carol A Ceresola
Carol A. Ceresola

California Acknowledgment Form

A notary public or other officer completing this certificate verifies only the identity of the individual who signed the document to which this certificate is attached, and not the truthfulness, accuracy, or validity of that document.

State of California
County of Plumas } ss.

On SEPTEMBER 7, 2016 before me, LAURA E. FEATHERSTONE ^{NOTARY PUBLIC}
(here insert name and title of the officer)
personally appeared DWIGHT EUGENE CERESOLA AND CAROL ANN CERESOLA

who proved to me on the basis of satisfactory evidence to be the person(s) whose name(s) is/are subscribed to the within instrument and acknowledged to me that he/she/they executed the same in his/her/their authorized capacity(ies), and that by his/her/their signature(s) on the instrument the person(s), or the entity upon behalf of which the person(s) acted, executed the instrument.

I certify under PENALTY OF PERJURY under the laws of the State of California that the foregoing paragraph is true and correct.

Seal



WITNESS my hand and official seal.

Laura E. Featherstone

Signature of Notary

Optional Information

To help prevent fraud, it is recommended that you provide information about the attached document below.

This is not required under California State notary public law.

Document Title: GRANT DEED # of Pages: _____

Notes

CROCKER MEADOWS EXP. 2

EXHIBIT A

PARCEL 1:

THE NORTHEAST QUARTER OF THE SOUTHWEST QUARTER OF SECTION 13, TOWNSHIP 23 NORTH, RANGE 14 EAST, MDBM (BOOK 1 OF PATENTS AT PAGE 381)

APN: 025-030-032

PARCEL 2:

THE NORTHEAST QUARTER OF THE NORTHWEST QUARTER OF SECTION 24, TOWNSHIP 23 NORTH, RANGE 14 EAST, MDBM (BOOK 1 OF PATENTS AT PAGE 754)

APN: 025-060-033

PARCEL 3:

THE SOUTHWEST QUARTER OF THE NORTHEAST QUARTER OF SECTION 24, TOWNSHIP 23 NORTH, RANGE 14 EAST, MDBM (BOOK 2 OF PATENTS AT PAGE 764)

APN: 025-060-035

PARCEL 4:

PARCEL B OF LOT LINE ADJUSTMENT RECORDED MAY 23, 1996 IN BOOK 681, PAGE 659 OF OFFICIAL RECORDS DESCRIBED AS FOLLOWS:

THE SOUTHWEST QUARTER OF THE NORTHWEST QUARTER;
THE WEST HALF OF THE SOUTHWEST QUARTER;
THE SOUTHEAST QUARTER OF THE SOUTHWEST QUARTER;
THE WEST HALF OF THE SOUTHEAST QUARTER OF SECTION 13, TOWNSHIP 23 NORTH, RANGE 14 EAST;

THE SOUTH HALF OF THE NORTHWEST QUARTER;
THE NORTHWEST QUARTER OF THE NORTHWEST QUARTER;
THE NORTHWEST QUARTER OF THE NORTHEAST QUARTER OF SECTION 24, TOWNSHIP 23 NORTH, RANGE 14 EAST MDM

APN: 025-030-033; 025-060-034, -036

PARCEL 5:

THE NORTHWEST ONE-QUARTER OF THE NORTHWEST ONE-QUARTER; AND THE EAST HALF OF THE NORTHWEST ONE-QUARTER; AND THE SOUTHWEST ONE-QUARTER OF THE NORTHEAST ONE-QUARTER OF SECTION 14, TOWNSHIP 23 NORTH, RANGE 14 EAST, M.D.B.M. (BOOK 6 OF PATENTS AT PAGE 232)

Excepting therefrom that portion described in Exhibit C attached.
APN: 025-030-008,

PARCEL 6:

THE SOUTHWEST ONE-QUARTER OF THE SOUTHWEST ONE-QUARTER OF SECTION 14, TOWNSHIP 23 NORTH, RANGE 14 EAST, M.D.B.M.; AND THE SOUTH HALF OF THE SOUTHEAST ONE-QUARTER OF SECTION 15, TOWNSHIP 23 NORTH, RANGE 14 EAST, M.D.B.M.; AND THE NORTHWEST ONE-QUARTER OF THE NORTHEAST ONE-QUARTER OF SECTION 22, TOWNSHIP 23 NORTH, RANGE 14 EAST M.D.B.M. (BOOK 6 OF PATENTS AT PAGE 306)

APN: 025-030-035; 025-460-003

PARCEL 7:

THAT PORTION OF THE SOUTHWEST QUARTER OF THE SOUTHEAST QUARTER OF THE SOUTHEAST QUARTER OF SECTION 11, TOWNSHIP 23 NORTH, RANGE 14 EAST, M.D.B.M., DESCRIBED IN EXHIBIT "D" ATTACHED.

APN: 025-030-040 (PORTION)

PARCEL 8:

THE SOUTH HALF OF THE NORTHWEST QUARTER OF THE NORTHWEST QUARTER OF SECTION 13, TOWNSHIP 23 NORTH, RANGE 14 EAST, M.D.B.M.

APN: 025-030-041

PARCEL 9:

ALL THAT CERTAIN REAL PROPERTY SITUATE IN TOWNSHIP 23 NORTH, RANGE 14 EAST, M.D.M., ACCORDING TO THE OFFICIAL PLAT THEREOF, IN AN UNINCORPORATED AREA OF THE COUNTY OF PLUMAS, STATE OF CALIFORNIA, BEING MORE PARTICULARLY DESCRIBED AS FOLLOWS:

SECTION 11:

THAT PORTION OF THE SOUTHWEST 1/4 OF THE SOUTHEAST 1/4 DESCRIBED IN EXHIBIT "D" ATTACHED.

SECTION 14:

THAT PORTION OF THE NORTH 1/2 OF THE NORTHEAST 1/4 DESCRIBED IN EXHIBIT "D" ATTACHED.

(BOOK 1 OF PATENTS, PAGE 752)

APN: 025-030-042 (PORTION)

PARCEL 10:

RESULTING PARCEL 1 OF LOT LINE ADJUSTMENT RECORDED SEPTEMBER 24, 2013, INSTRUMENT NO. 2013-6767 OFFICIAL RECORDS, FURTHER DESCRIBED AS FOLLOWS:

ALL THAT CERTAIN REAL PROPERTY SITUATE IN TOWNSHIP 23 NORTH, RANGE 14 EAST, M.D.M., ACCORDING TO THE OFFICIAL PLAT THEREOF, IN AN UNINCORPORATED AREA OF THE COUNTY OF PLUMAS, STATE OF CALIFORNIA, BEING MORE PARTICULARLY DESCRIBED AS FOLLOWS:

SECTION 14:

THE EAST 1/2 OF THE SOUTHEAST 1/4 AND THE SOUTHEAST 1/4 OF THE NORTHEAST 1/4.

EXCEPTING THEREFROM:

ALL THAT PORTION OF SAID EAST 1/2 OF THE SOUTHEAST 1/4 THAT LIES BOTH WESTERLY OF THE CENTERLINE OF BECKWOURTH-GENESEE ROAD AND SOUTHERLY OF A LINE DESCRIBED AS COMMENCING AT A POINT ON THE WEST LINE OF THE SOUTHEAST 1/4 OF THE SOUTHWEST 1/4 OF SAID SECTION 14 WHICH BEARS S 01° 30' 30" E, 499.69 FEET FROM THE NORTHWEST CORNER THEREOF; THENCE EAST, 2592.06 FEET TO A POINT ON THE WEST LINE OF SAID EAST 1/2 OF THE SOUTHEAST 1/4 OF SAID SECTION 14, THE TRUE POINT OF BEGINNING OF SAID LINE; THENCE FROM SAID TRUE POINT OF BEGINNING EAST, 766.60 FEET, MORE OR LESS, TO THE CENTERLINE OF SAID BECKWOURTH-GENESEE ROAD, THE TERMINUS OF SAID LINE.

ALSO EXCEPTING THEREFROM THAT PORTION CONVEYED TO THE COUNTY OF PLUMAS BY DEED RECORDED JULY 12, 2016, INST. NO. 2016-3498 OF OFFICIAL RECORDS.

ALSO EXCEPTING THEREFROM THAT PORTION DESCRIBED IN EXHIBIT "E" ATTACHED.

TOGETHER WITH:

ALL THAT PORTION OF THE SOUTHEAST 1/4 OF THE SOUTHWEST 1/4 AND THE SOUTHWEST 1/4 OF THE SOUTHEAST 1/4 LYING NORTHERLY OF THE FOLLOWING DESCRIBED LINE:

BEGINNING AT A POINT ON THE WEST LINE OF SAID SOUTHEAST 1/4 OF THE SOUTHWEST 1/4 WHICH BEARS S 01° 30' 30" E, 499.69 FEET FROM THE NORTHWEST CORNER THEREOF; THENCE FROM SAID POINT OF BEGINNING EAST, 2592.06 FEET TO THE EAST LINE OF SAID SOUTHWEST 1/4 OF THE SOUTHEAST 1/4, THE TERMINUS OF SAID LINE.

SECTION 23:

THE EAST 1/2 OF THE NORTHEAST 1/4.

EXCEPTING THEREFROM:

ALL THAT PORTION OF SAID EAST 1/2 OF THE NORTHEAST 1/4 OF SAID SECTION 23 LYING WESTERLY OF THE CENTERLINE OF BECKWOURTH-GENESEE ROAD.

ALSO EXCEPTING THEREFROM THAT PORTION CONVEYED TO THE COUNTY OF PLUMAS BY DEED RECORDED JULY 12, 2016, INST. NO. 2016-3497 OF OFFICIAL RECORDS.

APN: PTN. 025-030-043; 025-060-044

Exhibit B

To; Dwight Eugene & Carol Ceresola

March 1, 2016

From; Jim Scarborough, Watermaster

RECEIVED

MAR 18 2016

Wildlife Conservation Board

RE: Division of water rights appurtenant to decreed lands of original claimant Frank Carmichael, Middle Fork Feather River Decree 3095 (MFFR).

The Irrigated lands found within the decree may be located in Schedule 1, sheet 4, page 57 & 58, under the name of Frank Carmichael and total 1211.5 acres comprised in part or whole of sections 11, 13, 14, 23, 24, of T.23 N., R.14 E. & sections 18, 19, of T. 23 N., R. 15., M.D.B. & M. They may be located on the decree maps number 7 & 2.

The division of lands was requested solely by Dwight Ceresola and the representation of the lands divided was based upon his direction.

These lands are named in the Middle Fork Feather River Decree 3095, Plumas County, but are not part of or under the control of the State of California, Department of Water Resources, Watermaster Service Area (WSA).

The water "rights are of "special class" and are superior in priority and in right to all other rights in the group in which said rights in " special class "respectively occur" (para. 29. p. 18, decree 3095).

The right to divert water, "shall be for continuous usage without regard to season" (para. 30 p. 19, decree 3095).

The amount of water to be diverted from diversions dams 267 & 268, to irrigate the 1211.5 acres is 5 cubic feet per second (cfs). The purpose of use shall be for domestic, stockwatering, and irrigation. (para. 73, p. 45, decree 3095).

Exhibit C

Parcel Description

All that certain real property situate in an unincorporated area of the County of Plumas, State of California, being more particularly described as follows:

The northeast quarter of the northeast quarter of the northwest quarter of Section 14, Township 23 North, Range 14 East, M.D.B.&M., according to the Official Plat thereof.

APN: 025-030-039

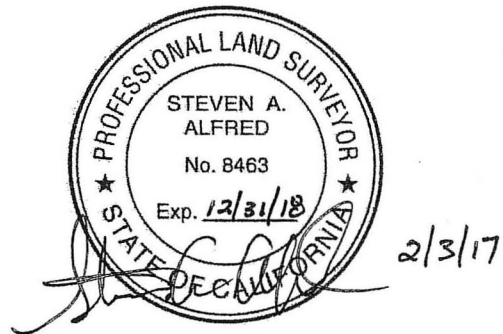

Exhibit D

Parcel Description

All that certain real property being portions of Sections 11 and 14, Township 23 North, Range 14 East, M.D.B.&M., according to the Official Plat thereof, situate in an unincorporated area of the County of Plumas, State of California, being more particularly described as follows:

All those portions of the southwest quarter of the southeast quarter of said Section 11, the southwest quarter of the southeast quarter of the southeast quarter of said Section 11, and the north half of the northeast quarter of said Section 14 lying easterly of the parcel conveyed to the County of Plumas by deed recorded July 12, 2016, Document Number 2016-0003499, Plumas County Official Records.

APN: 025-030-042 (portion)

APN: 025-030-040 (portion)



3/10/17

Exhibit E

Parcel Description

All that certain real property being a portion the southeast quarter of the northeast quarter of Section 14, Township 23 North, Range 14 East, M.D.B.&M., situate in an unincorporated area of the County of Plumas, State of California, bounded as follows:

A parcel of land bounded on the north by the north line of said southeast quarter of the northeast quarter; on the west and southwest by the centerline of Beckwourth-Genesee Road; and on the east by the parcel conveyed to the County of Plumas by deed recorded July 12, 2016, Document Number 2016-0003498, Plumas County Official Records.

Said parcel containing 9.4 acres, more or less.

APN: 025-030-043 (portion)



4/4/17

Project: Crocker Meadows Wildlife Area,
Expansion #2

Project ID: 2014112

CERTIFICATE OF ACCEPTANCE

THIS IS TO CERTIFY that the interest in real property conveyed by the deed or grant, dated September 7, 2016, from Dwight Eugene Ceresola and Carol A. Ceresola, husband and wife as joint tenants to the STATE OF CALIFORNIA, is hereby accepted by the undersigned officer on behalf of the State of California, pursuant to authority conferred by authorization of the Wildlife Conservation Board, Department of Fish and Wildlife, Natural Resources Agency, State of California, adopted on August 30, 2016, and the grantee consents to the recordation thereof by its duly authorized officer.

APPROVED
STATE OF CALIFORNIA
DEPARTMENT OF GENERAL SERVICES

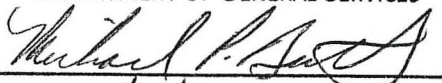
By: 
Dated: 12/19/2016

MICHAEL P. BUTLER, CHIEF
REAL PROPERTY SERVICES SECTION

STATE OF CALIFORNIA
Natural Resources Agency
Department of Fish and Wildlife

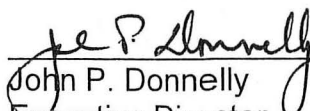
By: 
John P. Donnelly
Executive Director
Wildlife Conservation Board

Date: 11/9/16