

County: **Mendocino**
 USGS Quad: **Mallo Pass**

Thomas Guide Location
 CA Road Atlas
 NOAA Chart: **18640**

Latitude N Longitude W
 39 00' 30" 123 42'

Last Page Update : 7/1/1996

SITE DESCRIPTION:

This site includes a small tidal estuary formed at the mouth of Alder Creek. This site is at the north end of Manchester State Park. Seasonal inlet to Alder Creek with a small marsh along creek. San Andreas Fault is on this area and runs into the ocean

SEASONAL and SPECIAL RESOURCE CONCERN

The marsh provides habitat for many kinds of ducks and shorebirds that forage there year round. Salmonid migrations through the estuary would occur mostly during high water flow events during winter and spring.

RESOURCES OF PRIMARY CONCERN

Pt. Arena Mountain Beaver live in burrows and are present around this site. Do not drive response vehicles off road in the brush in the area.

Seabirds, shorebirds, waterfowl, wading birds, juvenile gulls, Caspian tern
 Snowy Plover (FT)(01-12), FWS Critical Habitat, nesting 03-08;

Pt. Arena Mountain Beaver (FE,SSC)

Anadromous salmonids: Coho salmon (FE,SE), Steelhead (FT):

- spawning runs (09-06)
- juveniles/smolts (02-08)

CULTURAL, HISTORIC, and ARCHEOLOGICAL SENSITIVITIES

Cultural, Historical, and Archeological sites are known to exist in the area, however, the exact locations of these sites must be ascertained by contacting the Native American Heritage Commission at (916) 653-4082 and State Office of Historical Preservation (916) 445-7000, and/or Ms. Leigh Jordan, Coordinator of the Northwest Information Center (707) 588-8455.

KEY CONTACTS: Trustee (T); Entry/Owner/Access (E); Cultural (C); or Other Assistance (O)

Type	Name / Title	Organization	Phone
O		NORCOM State Parks Dispatch 24-hours	(916) 358-1300
O		Mendocino County Sheriff's Dept.	(707) 463-4086
T		California State Parks Mendocino District	(707) 937-5804
T		California Dept of Fish and Game, Fort Bragg	(707) 964-9078
O	Troy Nicolini	National Weather Service Woodley Island	(707) 442-2171

ADDITIONAL SITE SUMMARY COMMENTS:

For further information about coastal access in this area, please refer to the California Coastal Commission's California Coastal Access Guide. For photos of the coastline in this area, please refer to the California Coastal Records Project (www.californiacoastline.org).

1-482 -B Site Strategy - Alder Creek

County and Thomas Guide Location
CA Road Atlas Mendocino

NOAA CHART
18640

1-482 -B
Latitude N Longitude W
39 00' 30 123 42'

CONCERNS and ADVICE to RESPONDERS:

Last Page Update :

Try to minimize oil spread into the back part of the small estuary where clean up would be difficult. Contact State Parks prior to initiating response here due to presence of endangered Pt. Arena Mountain Beaver and threatened snowy plover.

HAZARDS and RESTRICTIONS:

Access road is narrow with eroded cliff drop offs to the north.

SITE STRATEGIES

The site will only need protection if the surf is high enough to bring oil over the berm and into the pond area.

Strategy 1-482.1 Objective: Pre-clean debris before oil arrives.

Pre-clean debris before oil arrives.

Strategy 1-482.2 Objective: Boom across the mouth of the creek to prevent oil from spreading into the small estuary

On low flows, stretch a boom across the mouth to exclude oil and protect vegetation from oiling.

Table of Response Resources

strategy number	harbor boom	swamp boom	Other boom type	sorb boom	Anchoring no	tvpe and gear	Boom boat	Skiffs punts	Skimmers No	Type	Special Equipment or comment No and kinds	staff deploy	Staff tend
1-482.1	0	0	0	0	0		0	0	0		0		
1-482.2	0	300	0	0	0		0	0	0		0	5	

LOGISTICS

DIRECTIONS: to site (by land and/or by water, to nearest launch ramp and are access permits required.)

Take U.S. hwy 101 north to state route 128 just north of Cloverdale. Follow route 128 to state hwy 1. Go south on state hwy 1 and take the first road south of Alder Creek bridge (Between M.P. 22.50 and M.P.22.48). Follow road about 1 mile to creek mouth. Either side of creek easily accessible by heavy machinery. This site includes a small tidal estuary formed at the mouth of Alder Creek. This site is at the north end of Manchester State Park.

LAND ACCESS: ATV access across a washed out dirt road

WATER LOGISTICS:

Limitations: depth, obstruction
Launching, Loading, Docking
and Services Available:

FACILITIES, STAGING AREAS, POSSIBLE FIELD POSTS AND EQUIPMENT AVAILABLE:

COMMUNICATIONS PROBLEMS: Remote, limited communications

ADDITIONAL OPERATIONAL COMMENTS:

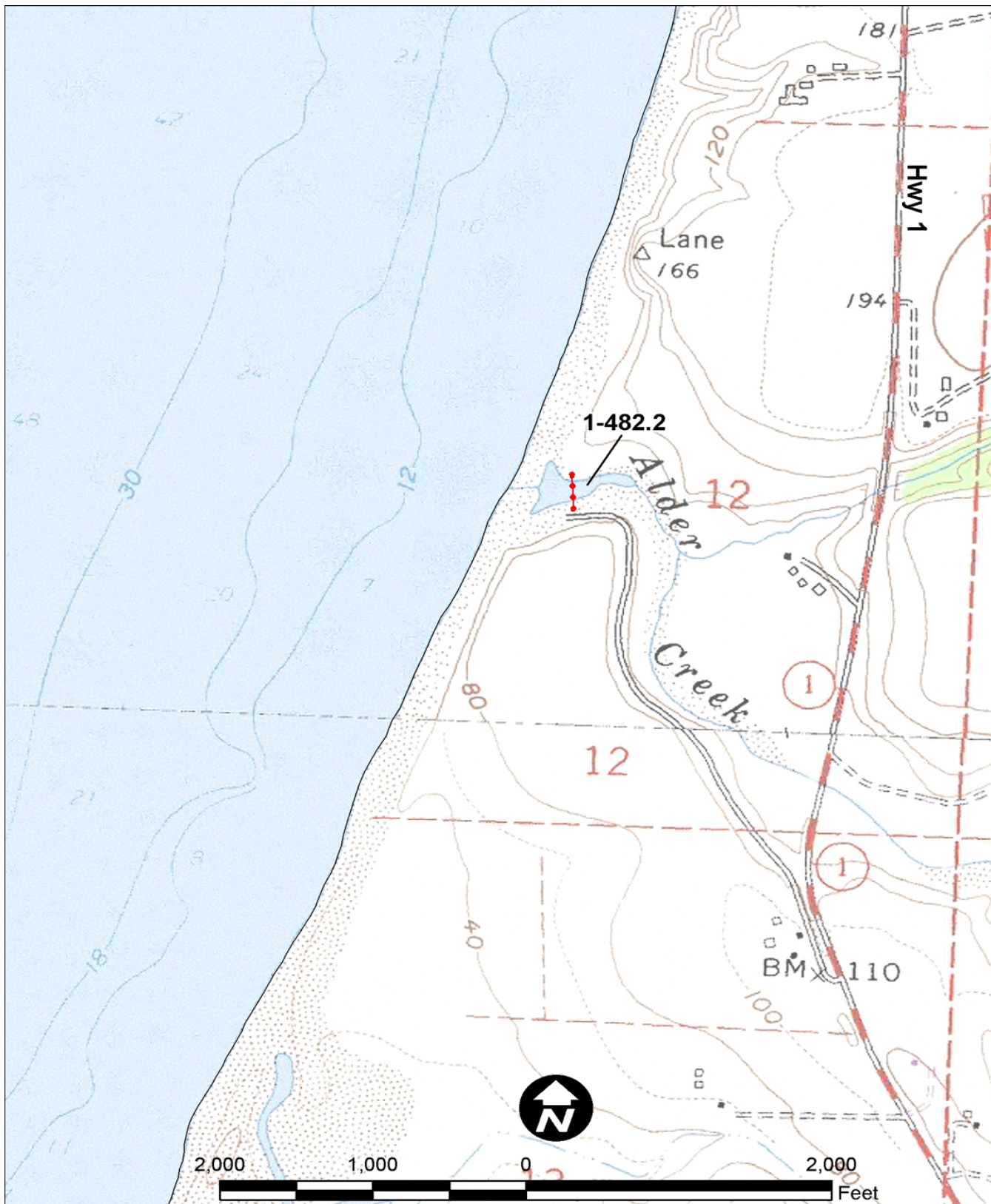

CALIFORNIA DEPARTMENT OF FISH & GAME (OSPR) and UNITED STATES COAST GUARD
 Site: 1-482 Site Name: Alder Creek

Jeff Dayton (OSPR) & Greg Ewing (OSPR)
 Date: May18, 2011

