

1-345 -A Site Summary- Elk River & Marsh**1-345 -A**

County: **Humboldt**
USGS Quad: **Eureka**

Thomas Guide Location
CA Road Atlas
NOAA Chart: **18622**

Latitude N Longitude W
40 46' 124 12'

Last Page Update : 7/1/1996

SITE DESCRIPTION:

This site extends from the mouth of the Elk River on Humboldt Bay and includes the tidal marsh complex upstream. This site is within the City of Eureka and is also known as the Elk River Wildlife Sanctuary managed by the city. Tidal influence extends well upstream of the Highway 101 bridge. The inlet consists of sheltered tidal flats with eelgrass beds. Elk River spit is fine to medium grain sand.

SEASONAL and SPECIAL RESOURCE CONCERN

This is a high bird use area year round.

RESOURCES OF PRIMARY CONCERN

The Elk river estuary has extensive wetlands and saltmarsh that would be difficult to clean-up if oil enters that environment.

Wading birds, shorebirds, waterfowl (01-12), migratory waterfowl and shorebirds (10-04); Brant (10-06), Kingfishers, Egrets, raptors incl. Osprey (01-12).

harbor seals, river otters

Anadromous salmonids: Coho (FT,ST) and Chinook (FT) salmon, Steelhead (FT) and Coastal cutthroat (SSC) trouts:

- spawning runs (08-06)
- juveniles/smolt (02-08)

Longfin smelt (ST)

Tidewater goby (FE,SSC), FWS Critical Habitat

Pacific lamprey

Pacific herring spawn on eelgrass (11-03).

Larval and juvenile flatfishes and herring utilize this area.

Other non-com'l fish spp. utilize the eelgrass beds (habitat).

eelgrass beds

beach layia (FE,SE), Humboldt Bay wallflower (FE,SE)

CULTURAL, HISTORIC, and ARCHEOLOGICAL SENSITIVITIES

Cultural, Historical, and Archeological sites are known to exist in the area, however, the exact locations of these sites must be ascertained by contacting the Native American Heritage Commission at (916) 653-4082 and State Office of Historical Preservation (916) 445-7000, and/or Ms. Vicki Bates, Coordinator of the North Coast Information Center (707) 482-1822.

KEY CONTACTS: Trustee (T); Entry/Owner/Access (E); Cultural (C); or Other Assistance (O)

| Type | Name / Title | Organization | Phone |
|------|--------------------------------|---|----------------|
| T | | CA Dept of Fish and Game Wildlife Area | (707) 445-6493 |
| O | | Eureka Police Department | (707) 441-4044 |
| T | | City of Eureka | (707) 441-4203 |
| C | Briana Fraley | Table Bluff Reservation Wiyot Tribe | (707) 733-5055 |
| O | Suzie Howser Dock Master | Humboldt Bay Harbor District | (707) 443-0801 |
| O | Troy Nicolini | National Weather Service Woodley Island | (707) 442-2171 |
| O | Scott Parsons Terminal Manager | Chevron Marine Terminal | (707) 444-7850 |

ADDITIONAL SITE SUMMARY COMMENTS:

For further information about coastal access in this area, please refer to the California Coastal Commission's California Coastal Access Guide. For photos of the coastline in this area, please refer to the California Coastal Records Project (www.californiacoastline.org).

1-345 -A Site Strategy - Elk River & Marsh

County and Thomas Guide Location

CA Road Atlas Humboldt

NOAA CHART

18622

1-345 -A

Latitude N

40 46'

Longitude W

124 12'

Last Page Update :

CONCERNS and ADVICE to RESPONDERS:

Oiling of sloughs and marsh complex could cause long term damage to important habitats. Avoid anchoring in eelgrass beds.

HAZARDS and RESTRICTIONS:

There is extensive shoaling in this area, and a significant number of potentially submerged pilings from an old pipeline trestle in the mouth of the river.

SITE STRATEGIES

Shallow sloughs, extensive mudflats. Depth limitations may complicate vessel access.

Strategy 1-345.1 Objective: Shut key-locked drop gates to prevent tidal exchange into the marsh

Keys are available at either the Chevron Terminal in Eureka or from the City of Eureka Public Works Office.

Strategy 1-345.2 Objective: Boom the mouth of Elk River to exclude oil.

Exclusion boom the river mouth and collect oil if possible.

Strategy 1-345.3 Objective: Collect oil when enough is present to skim.

Use a skimmer to collect oil from off the water into collection.

Strategy 1-345.4 Objective: Deflect oil from the mouth of the river north into the quiet water on the eastern shore of the bay.

Deflection booming: Install a chevron extending from the northern tip of the sand spit and out (N.W. direction) to the old piles in front of the river mouth. From that point, deploy the boom (E.) into the quiet water on the eastern shore of Humboldt Bay and north of the river mouth. Deployed in 2008, the strategy was modified with the addition of 1000' of boom in order to reach completely across the channel at high tide.

This would be an alternative response to Strategy #2 at this site, and is intended to replace that strategy as the primary deployment to be employed at this site. The original strategy will remain as an alternative that could be used when or if this strategy is not feasible, or as a second layer of protection.

Table of Response Resources

| strategy number | harbor boom | swamp boom | Other boom type | sorb boom | Anchoring no | type and gear | Boom boat | Skiffs punts | Skimmers No | Type | Special Equipment or comment No and kinds | staff deploy | Staff tend |
|-----------------|-------------|------------|-----------------|-----------|--------------|-------------------------|-----------|--------------|-------------|---------|---|--------------|------------|
| 1-345.1 | 0 | 0 | 0 | 0 | 0 | | 0 | 0 | 0 | 1 | Key | 2 | |
| 1-345.2 | 1400 | 0 | 0 | 300 | 5 | 22 lb+ Danforth anchors | 0 | 1 | | | | 4 | |
| 1-345.3 | 0 | 0 | 0 | 0 | 0 | | 0 | 0 | 1 | SSS/SPS | 0 | 2 | |
| 1-345.4 | | 2400 | 0 | 0 | 8 | 22 lb+ Danforth anchors | | 1 | 0 | 0 | | 4 | |

LOGISTICS

DIRECTIONS: to site (by land and/or by water, to nearest launch ramp and are access permits required.)

From southbound U.S. hwy 101 (South Broadway Street) in Eureka, turn right at the "Coastal Access" sign at Hilfiker Lane (M.P. 75.740) and continue to the end of the street. Park on the street or in the parking lot on the banks of the Elk River. There is also access to the river mouth from the end of Truesdale Street, just south of the Bayshore Mall. This site extends from the mouth of the Elk River on Humboldt Bay and includes the tidal marsh complex upstream. This site is within the City of Eureka and is also known as the Elk River Wildlife Sanctuary managed by the city. Tidal influence extends well upstream of the Highway 101 bridge.

LAND ACCESS: accessible to all vehicle types including heavy equipment

WATER LOGISTICS: The water depth is variable, probably submerged pilings.

Limitations: depth, obstruction

Launching, Loading, Docking and Services Available: Access is possible from Humboldt bay with shallow draft vessels recommended for this response location.

FACILITIES, STAGING AREAS, POSSIBLE FIELD POSTS AND EQUIPMENT AVAILABLE:

There are small parking lots near the foots of Hilfiker and Truesdale streets where local response equipment and supplies could be staged for a response at this site.

COMMUNICATIONS PROBLEMS:

ADDITIONAL OPERATIONAL COMMENTS:

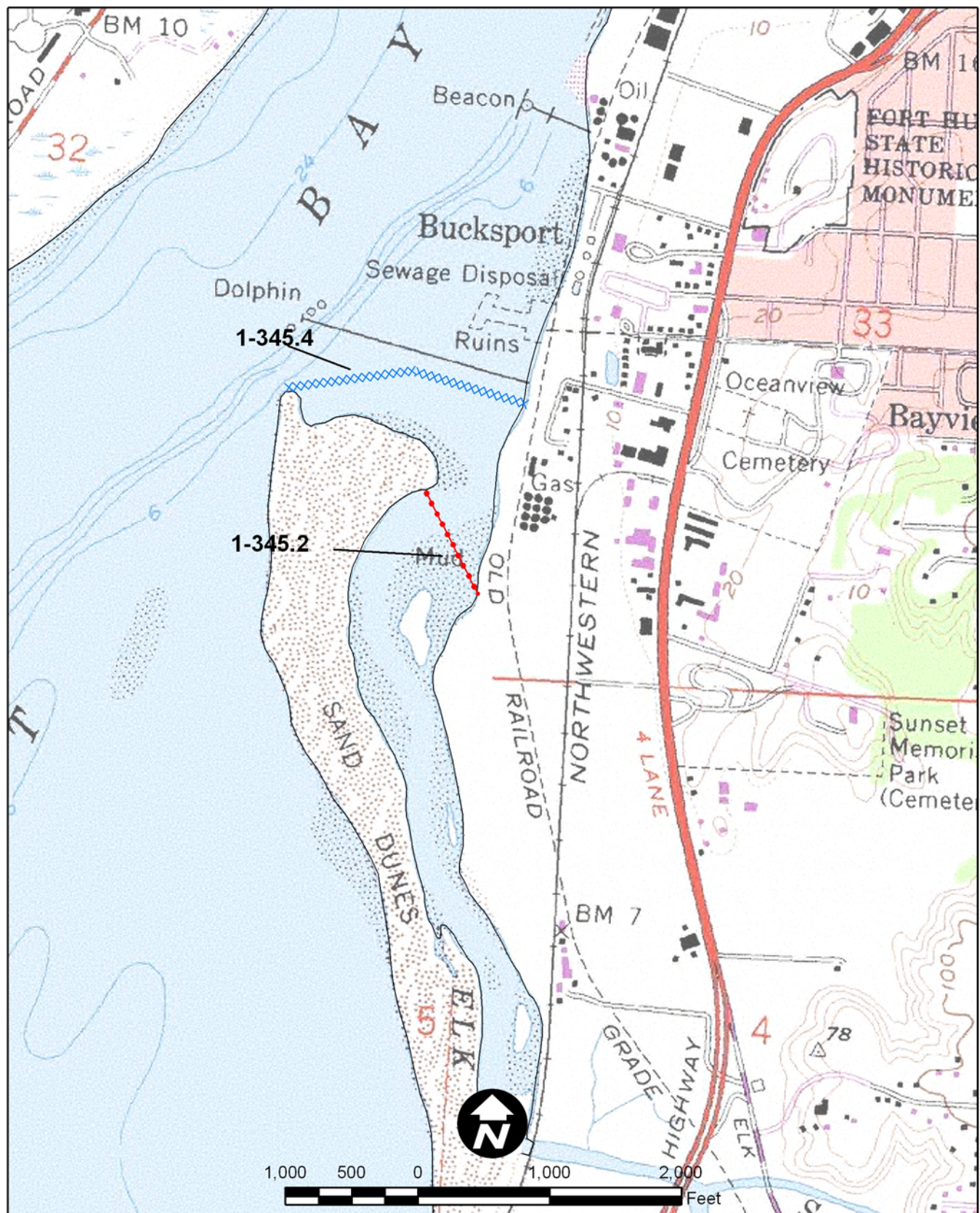

CDFG-OSPR & USCG Site: 1-345 Name: Elk River and Marsh

Kris Wiese (OSPR) & Jo Sanders (OSPR) Date: July 17, 2008

